

F

光电开关系列

PHOTO-ELECTRIC LIGHT CONTROL SERIES

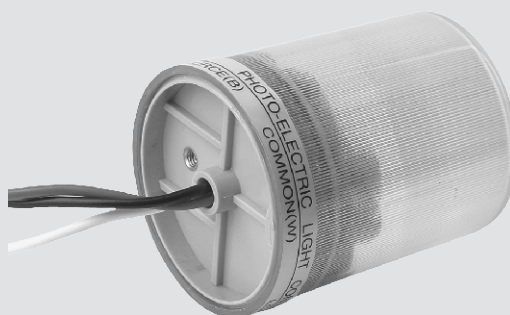

AS 系列 Series

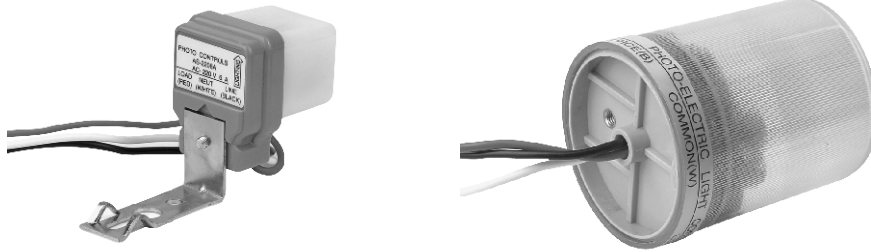

LR AS-

| 型号 Model | 电压 Voltage |
|----------|------------|
| AS-2203 | AC220V 3A |
| AS-2206 | AC220V 6A |
| AS-2210 | AC220V 10A |
| AS-11003 | AC110V 3A |
| AS-11006 | AC110V 6A |
| AS-11010 | AC110V 10A |

LR AS0-

| 型号 Model | 电压 Voltage |
|-----------|------------|
| ASO-2203 | AC220V 3A |
| ASO-2206 | AC220V 6A |
| ASO-2210 | AC220V 10A |
| ASO-2215 | AC220V 15A |
| ASO-11003 | AC110V 3A |
| ASO-11006 | AC110V 6A |
| ASO-11010 | AC110V 10A |
| ASO-11015 | AC110V 15A |

应用 Application:

路灯、工厂、花园、港口、机场、农场、公园，其他任何地方。

Street Light, Factory, Garden, Harbor, Airport, Farm, Park, any other place.

特性 Features:

紧凑的、可靠的照明控制组成密封的CDS光电池和折成金属分程传递的确保电子开关。

Compact, reliable lighting controls consist of hermetically sealed CDS photocell and snap action bimetallic relay to insure electrical

电路连接 Electrical connection:

在使用荧光灯时，在稳压器的主要边连接控制单元，先连红色主导线以示安装。

在使用白炽灯时，连接黑色的主导线和白色的主导线（普通的）到电源，红色主导线和白色主导线到灯的负载。

At using for fluorescent lamp, connect the control unit in the primary side of stabilizer, connect red-lead wire first for safety.

For incandescent lamp, connect black-lead wire and white-lead(common) to power souce, red-lead wire and white lead to lamp load.

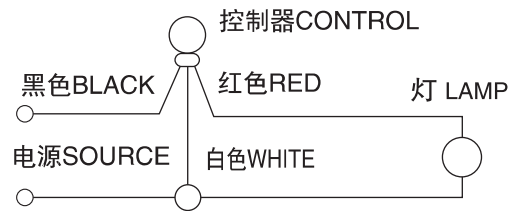
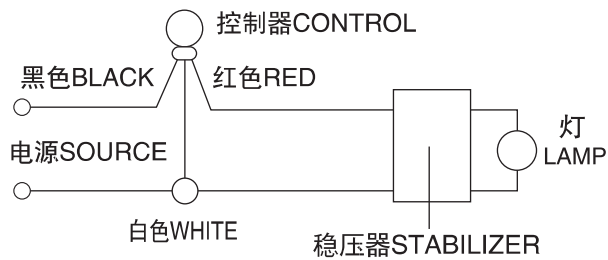
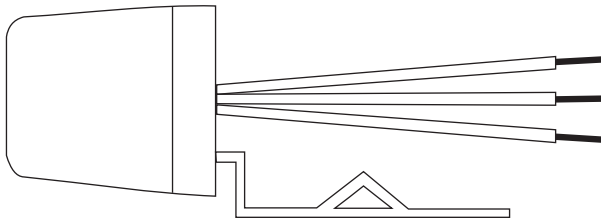

安装尺寸 Installation dimensions

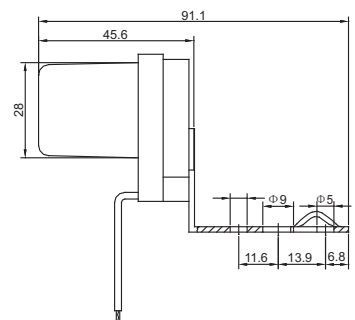
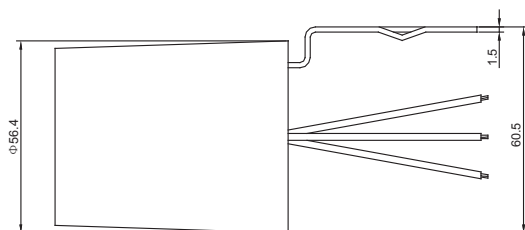
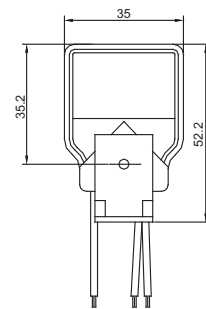
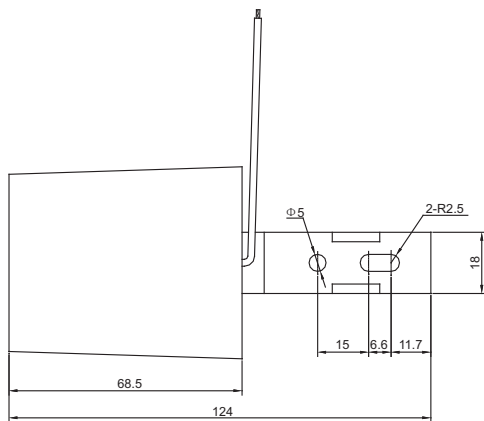

G

电流电压表、频率表系列

VOLTMETER & AMMETER SERIES



LRD 电流电压表系列 Voltmeter, ammeter series

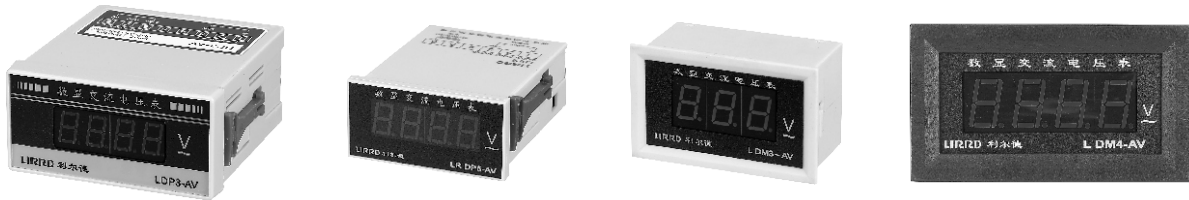

特点Features

- 转换比率2.5次/秒
- 零点调整（固定小数）
- 数字范围±1999 (LDP3-□ □) (LRDP6-□ □)
- Conversion ratio 2.5/s
- Zero adjustment (Fixed decimal point)
- Display range ±1999 (LDP3-□ □) (LDP6-□ □)

型号及含义 Type and meaning

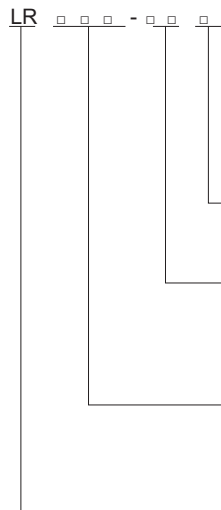

量程代号或量程 Measuring Range Code Or Measuring range

AV: 交流电压 DV: 直流电压 AV: AC Voltage DV: DC Voltage
AA: 交流电流 DA: 直流电流 AA: AC Ampere DA: DC Ampere

DP3: 3位半LED显示: (外形48×96mm仅DP3型号)
DM3: 3位LED显示: (外形42×69mm仅DM3型号)
DP6: 3位半LED显示: (外形36×72mm仅DP6型号)
DM4: 3位半LED显示: (外形46×82mm仅DM4型号)

利尔德 LIERD

供电电源 Power source

| 型号规格 Model & Spec. | 工作电源 Operating voltage |
|-----------------------|--------------------------------------------------------------|
| LRDP3 系列 series | AC 110/220V |
| LRDP6 系列 series | AC/DC 85~265V 自由输入 Input free |
| LRDM3 系列 series | AC/DC 85/265V 自由输入 Input free 或AC/DC 8~13.5V 自由输入 Input free |
| LRDM4 系列 series | DC5V/70mA |

交流数字电压表 AC digital voltmeter

| 型号规格 Model | 量程 Range | 分辨力 Resolving power DP3, DP6 | 输入阻抗 Input Resistance | 互感器变比 PT | 测量精度 Measuring accuracy | 最大允许输入 Max. input |
|---------------|-------------|---------------------------------|--------------------------|-------------------|----------------------------|----------------------|
| LDP□ -AV0.2 | 200mV | 100mV | 10MΩ | 直接输入 Direct input | ±0.5%F.S±2Digit | 5V (峰值Peak) |
| LDP□ -AV2 | 2V | 1mV | 10MΩ | 直接输入 Direct input | ±0.5%F.S±2Digit | 10V (峰值Peak) |
| LDP□ -VV20 | 20V | 10mV | 10MΩ | 直接输入 Direct input | ±0.5%F.S±2Digit | 50V (峰值Peak) |
| LDP□ -LAV200 | 200V | 100mV | 10MΩ | 直接输入 Direct input | ±0.5%F.S±2Digit | 500V (峰值Peak) |
| LDP□ -LAV600 | 600V | 1V | 10MΩ | 直接输入 Direct input | ±1%F.S±2Digit | 1000V (峰值Peak) |
| LDP□ -AV3K | 3KV | 10V | 10MΩ | 3KV:100V | ±1%F.S±2Digit | 1000V (峰值Peak) |
| LDP□ -AV10K | 10KV | 10V | 10MΩ | 10KV:100V | ±0.5%F.S±2Digit | 1000V (峰值Peak) |

交流数字电流表 AC digital ammeter

| 型号规格 Model | 量程 Range | 分辨力 Resolving power DP3, DP6 | 互感器变比 PT | 测量精度 Measuring accuracy | 最大允许输入 Max. input |
|---------------|-------------|---------------------------------|-------------------|----------------------------|----------------------|
| LDP□ -AA0.2 | 200mA | 100uA | 直接输入 Direct input | ±0.5%F.S±2Digit | 500mA |
| LDP□ -AA2 | 2A | 1mA | 直接输入 Direct input | ±0.5%F.S±2Digit | 5A |
| LDP□ -AA20 | 20A | 10mA | 20A:5A | ±0.5%F.S±2Digit | 1.2F.S |
| LDP□ -AA50 | 50A | 100mA | 50A:5A | ±1%F.S±2Digit | 1.2F.S |
| LDP□ -AA100 | 100A | 100mA | 100A:5A | ±0.5%F.S±2Digit | 1.2F.S |
| LDP□ -AA150 | 150A | 100mA | 150A:5A | ±0.5%F.S±2Digit | 1.2F.S |
| LDP□ -AA200 | 200A | 100mA | 200A:5A | ±0.5%F.S±2Digit | 1.2F.S |
| LDP□ -AA500 | 500A | 1A | 500A:5A | ±1%F.S±2Digit | 1.2F.S |
| LDP□ -AA1000 | 1000A | 1A | 1000A:5A | ±0.5%F.S±2Digit | 1.2F.S |
| LDP□ -AA1500 | 1500A | 1A | 1500A:5A | ±0.5%F.S±2Digit | 1.2F.S |
| LDP□ -AA2000 | 2000A | 1A | 2000A:5A | ±0.5%F.S±2Digit | 1.2F.S |

直流数字电压表 DC digital voltmeter

| 型号规格 Model | 量程 Range | 分辨率 Resolving power DP3, DP6 | 输入阻抗 Input Resistance | 测量精度 Measuring accuracy | 最大允许输入 Max. input |
|---------------|-------------|---------------------------------|--------------------------|----------------------------|----------------------|
| LDP□ -DV0.2 | 200mV | 100uV | 10MΩ | ±0.5%F.S±2Digit | 10V |
| LDP□ -DV2 | 2V | 1mV | 10MΩ | ±0.5%F.S±2Digit | 100V |
| LDP□ -DV20 | 20V | 10mV | 10MΩ | ±0.5%F.S±2Digit | 500V |
| LDP□ -DV200 | 200V | 100mV | 10MΩ | ±0.5%F.S±2Digit | 750V |
| LDP□ -DV500 | 500V | 1V | 10MΩ | ±1%F.S±2Digit | 800V |

直流数字电流表 DC digital ammeter

| 型号规格 Model | 量程 Range | 分辨率 Resolving power DP3, DP6 | 互感器变比 PT | 测量精度 Measuring accuracy | 最大允许输入 Max. input | 内部阻抗 Internal impedance |
|---------------|-------------|---------------------------------|-------------------|----------------------------|----------------------|----------------------------|
| LDP□ -DA0.000 | 20.2mA | 100uA | 直接输入 Direct input | ±0.5%F.S±2Digit | 10mA | 1KW |
| LDP□ -DA0.002 | 2mA | 1mA | 直接输入 Direct input | ±0.5%F.S±2Digit | 100mA | 100W |
| LDP□ -DA0.02 | 20mA | 10mA | 直接输入 Direct input | ±0.5%F.S±2Digit | 500mA | 10W |
| LDP□ -DA02 | 200mA | 100mA | 直接输入 Direct input | ±0.5%F.S±2Digit | 1A | 1W |
| LDP□ -DA2 | 2A | 1mA | 直接输入 Direct input | ±0.5%F.S±2Digit | 5A | 0.1W |
| LDP□ -DA20 | 20A | 10mA | 20A:75mV | ±0.5%F.S±2Digit | 1.5F.S | 5MW |
| LDP□ -DA30 | 30A | 100mA | 30A:75mV | ±1%F.S±2Digit | 1.5F.S | 5MW |
| LDP□ -DA50 | 50A | 100mA | 50A:75mV | ±1%F.S±2Digit | 1.5F.S | 5MW |
| LDP□ -DA100 | 100A | 100mA | 100A:75mV | ±0.5%F.S±2Digit | 1.5F.S | 5MW |
| LDP□ -DA150 | 150A | 100mA | 150A:75mV | ±0.5%F.S±2Digit | 1.5F.S | 5MW |
| LDP□ -DA200 | 200A | 100mA | 200A:75mV | ±0.5%F.S±2Digit | 1.5F.S | 5MW |
| LDP□ -DA300 | 300A | 1A | 300A:75mV | ±1%F.S±2Digit | 1.5F.S | 5MW |
| LDP□ -DA500 | 500A | 1A | 500A:75mV | ±1%F.S±2Digit | 1.5F.S | 5MW |
| LDP□ -DA1000 | 1000A | 1A | 1000A:75mV | ±0.5%F.S±2Digit | 1.5F.S | 5MW |
| LDP□ -DA1500 | 1500A | 1A | 1500A:75mV | ±0.5%F.S±2Digit | 1.5F.S | 5MW |
| LDP□ -DA2000 | 2000A | 1A | 2000A:75mV | ±0.5%F.S±2Digit | 1.5F.S | 5MW |

说明 Instruction

- (1) 测量精度的测试环境条件为：温度 $20\pm 2^{\circ}\text{C}$ 相对湿度45-75%。
- (2) 表中所列配电流互感器、电压互感器、分流器其型号规格为基本型。其它量程如交流一次额定电流为10A、15A、30A、75A、250A、1500A……，交流一次额定电压为1KV、6KV、11KV、35KV、110KV……均可按用户要求供货。
- (3) 配交流电流互感器其二次额定电流为5A，配交流电压互感器其二次额定电压为100V，配直流电流分流器其二次额定电压为75mV，若二次额定电流电压为其它数值，用户须予以说明。
- (4) 根据用户要求仪表与电流互感器、电压互感器、分流器可以配套供货。
- (5) 本仪表可以通过内部设置的小数点开关和量程开关同步调整仪表的使用量程。

- (1) Measuring accuracy in ambient temperature of $20\pm 2^{\circ}\text{C}$, humidity of 45% to 75% R.H.
- (2) The list of item CT and PT mode is basic model, the other scale for example, rated current 10A, 15A, 30A, 75A, 250A, 1500A……, rated current 1KV, 6KV, 11KV, 35KV, 110KV……, it according to customer offers.
- (3) With AC CT of the second ampere is 5A, AC PT of the second voltage is 100V, DC divider of the second voltage is 75mV. If the second ampere and voltage is other value, customer need to remark.
- (4) According to customer requirement, the meter can be offered with CT or PT.
- (5) The using scale of the meter can be adjusted by pushing the decimal point setting switch and the scale setting switch of the meter.

技术参数 Technical parameters

| | | | |
|---------------|------------------------------|--------------------------|--------------------------------|
| 输入方式 A/D转换 | Input mode A/D convert | 单端输入 双重积分 | Single-end Input Dual slope |
| 测量速度 | Sampling time | 约2.5次/秒 | Abt. 2.5 sec |
| 频率范围 | Frequency range | 40~200Hz (仅对交流) | Only for AC |
| 溢出显示 | Over input indication | "1" or "1"只显示“-” | (仅对±直流) Only"-display |
| 极性显示 | Polarity display | (only DC) | |
| 显示 | Display | 红色数码管(14.2mmH) | Red LED (14.2mmH) |
| 电源 | Aux. power supply | AC 110/220V±10%, 50/60Hz | |
| 功耗 | Power consumption | ≤4.5VA | |
| 耐压 | Dielectric withstand voltage | AC 1500V 1min | |
| 绝缘电阻 | Insulation resistance | DC 500V ≥100M | |
| 重量 | Weight | ≤280g | |

频率表系列 Frequency meter series

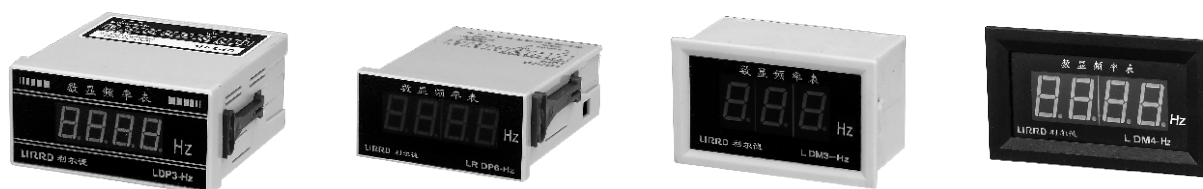

频率表系列功能特点 Function characteristics of frequency meter series

- (1) 产品主要适用于测量各种工业用电的频率
 - (2) LED高亮显示，读数直观，分辨率高。
 - (3) 输入信号电平范围75~300VAC，或200~480VAC。
 - (4) 输入信号光电隔离，抗干扰能力强。
- (1) Product is mainly used for measuring the frequency of kinds of industrial power.
- (2) LED high bright display. With visual reading and high resolution power.
- (3) Level range of input signal 75~300VAC or 200~480VAC.
- (4) Photoelectric isolating of input signal, with strong anti-interference capability.

频率表技术参数 T

| 类别 Classification | 数字式工业用电频率显示表 Digital type industrial power frequency display meter | | | |
|---------------------------------------|--------------------------------------------------------------------------------------------------------------------------|------------------|-------------------|-------------------|
| 型号 Model | DP3-Hz | DP6-Hz | DM3-Hz | DM4-Hz |
| 额定工作电压 Operating voltage | 85~265VAC/DC 自由输入，其他电压可定制 Input free, between 85~285VAC/DC other supply voltage upon request | | | |
| 输入信号 Input signal | 75~300VAC或200~480VAC，光电隔离 Photoelectric isolating | | | |
| 外形尺寸 (mm) Outline dimension | 48W x 96H x 112D | 36W x 72H x 97D | 42W x 69H x 35D | 46W x 82H x 18D |
| 精度等级 Precision grade | ±0.05%±1个字(23℃±5℃) | | | |
| 频率测量范围 Measuring range of frequency | 0.1Hz~999.9Hz | | | |
| LED显示方式 LED display mode | 4位高亮、字高0.56寸LED显示，小数点固定第2位LED 4 bits high bright, LED display of 0.56 digit height, decimal point fixed No. 2 bit LED | | | |
| 功率消耗 Power consumption | 小于 Less than 4VA | 小于 Less than 4VA | 小于Less than 1.5VA | 小于Less than 1.2VA |
| 安装方式 Installation mode | 面板嵌入式Panel built-in type | | | |
| 开孔尺寸 (mm) Hole dimension | 45W x 91H | 31W x 66.5H | 38W x 65H | 39.2W x 75H |
| 抗干扰能力 Anti-interference capability | AC2kV或DC500V脉冲宽度1uS扰动下频率表工作正常 AC2kV or DC500V impuse width, frequency meter works normally under 1uS disturbance | | | |
| 仪表使用环境 Operating environment | 环境温度：-10~+50℃，环境湿度：35~85%RH Ambient temperature :-10~+50℃, Environmental humidity:35~85%RH | | | |

端子连接 Terminal connection

LDP6

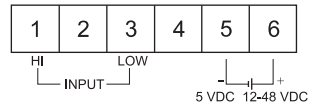
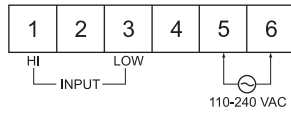

LDP3

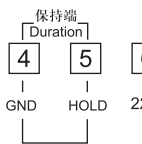
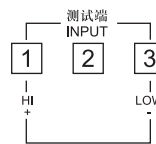
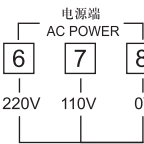
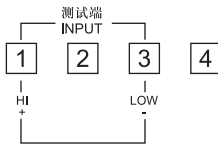

LDM3

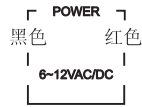
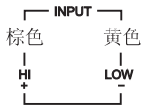

外形及表盘加工尺寸 The outside dimensions and mounting

LDP6

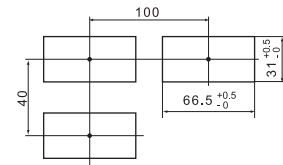
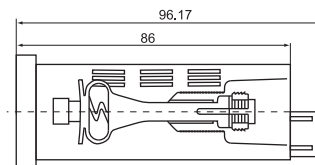
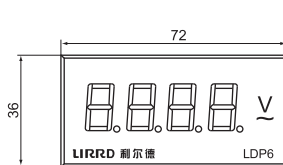

LDP3

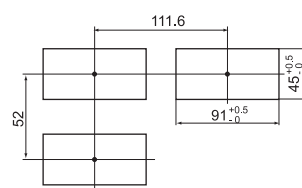
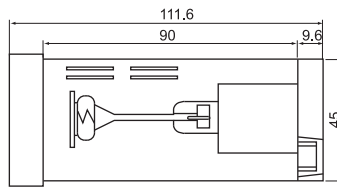
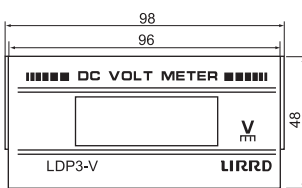

LDM3

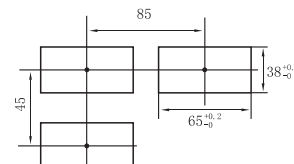
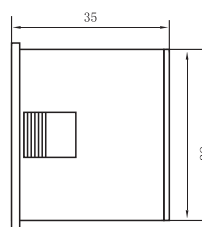
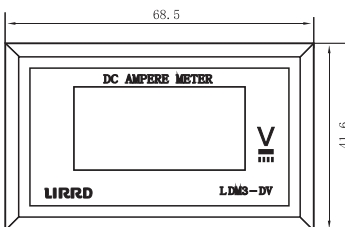

LDM4

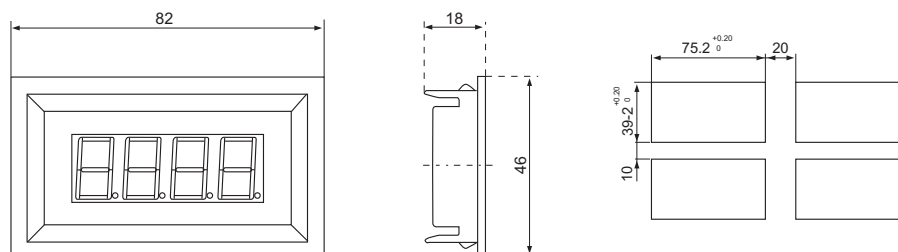

使用保存注意事项 Notice for operation and storage

- (1) 适宜使用环境温度 $0^{\circ}\text{C}\sim 40^{\circ}\text{C}$ ，相对湿度85%以下。
 - (2) 本仪表校准时间间隔为一年。
 - (3) 注意防止震动和冲击，不要在有超量灰尘和超量有害化学药品和气体等地方使用。
 - (4) 若输入信号伴随高频干扰，应在线里用高频过滤器。
 - (5) 输入导线不宜过长。如被测信号输出端与仪表距离不能缩短，请用双绞屏蔽线,屏蔽层与信号低端相连。
 - (6) 若长期存入未使用时，请每三个月通电一次，通电时间一次不少于4小时。
 - (7) 长期保存应避免直射光线，宜存放在 $-10^{\circ}\text{C}\sim 70^{\circ}\text{C}$ ，湿度60%以下的地方。切勿和有机溶剂或油物接触。
-
- (1) Use in ambient temperature of 0°C to 40°C , relative humidity less then 85% R.H.
 - (2) The meter calibration interval time is one year.
 - (3) Avoid using instruments in an area surrounded by vibrations or shock, dust, organic corrosive materials of gas.
 - (4) If the input signal with high-frequency noise, use a High-pass FILTER IN THE INPUT SIGNAL LINE.
 - (5) Input wire should not be too long. If measured signal and meter is long, please use a 2-core shielded cable, and connect its outer shield to the LO side at a signal source.
 - (6) If the digit meter relay is not used for a long time. Please connect power supply once every three months, not less than 4 hours each time.
 - (7) Long time for storing the meter in the shade with no high light-line with temperature of -10°C to 70°C , and humidity less than 60% Don't contact with organic solvents or gas.