

LJQX-30F Series

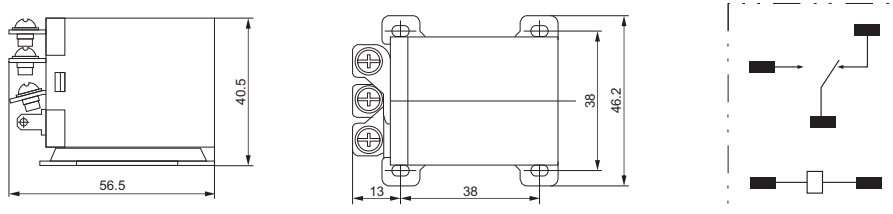

Model		LJQX-30F/1Z	LJQX-30F/2Z
Dimension(mm)		55.7×46.5×40.4	55.7×46.5×40.4
Contact Form		1Z 1H 1D	2Z 2H 2D
Contact Material		Silver alloy	
Resistance Performance Of Contactor Capacity		40A/28VDC 40A/250VAC	
Coil Power at 23℃	DC(W)	<2.5W	
	AC(VA)	<5.5VA	
Coil Voltage	DC(V)	6~220V	
	AC(V)	6~380V	
Pick-up Voltage at 23℃		DC≤75% AC≤80%	
Drop-out Voltage at 23℃		DC≥10% AC≥30%	
Max Voltage at 23℃		110%	
Contact Resistance(at 6VDC 1A)		≤100mΩ	
Dielectric Strength	Between Open Contacts	≥1000VAC 50Hz/1min Leakage current 1mA	
	Contacts pieces	≥1500VAC 50Hz/1min Leakage current 1mA	
	Between Coil & Contacts	≥1500VAC 50Hz/1min Leakage current 1mA	
Insulation Resistance(MΩ)at 500VDC		≥1000MΩ	
Service life	Electrical	10 ⁵ Times(Frequency: On1 Time/1S, Off1 Time/1S)	
	Mechanical	10 ⁸ Times(Frequency: 300 Time/1min)	
Ambient Temperature		-25℃~+55℃	
Terminal type		Screw Mounting	Welding type
Suitable socket		/	
Product Weight		100g	105g
Same Reference			

LJQX-30F/1Z Installation dimensions and connecting diagram



LJQX-30F Installation dimensions and connecting diagram

